

SONY®

START  
HERE



4-582-001-21(1)

©2016 Sony Corporation Printed in Korea

Startup Guide

Portable Ultra Short Throw Projector  
LSPX-P1



GB	Startup Guide	4	CZ	Počáteční instrukce	58
FR	Guide de démarrage	10	DK	Startvejledning	64
DE	Einführungsanleitung	16	FI	Aloituspapas	70
ES	Guía de inicio	22	SE	Startguide	76
IT	Guida di avvio	28	NO	Startveiledning	82
NL	Beknopte gids	34	HU	Használatbavételi útmutató	88
PT	Guia de início	40	EE	Kiirjuhend	94
GR	Οδηγός έναρξης	46	BG	Кратко ръководство	100
PL	Przewodnik uruchamiania	52	RO	Ghid de inițiere	106

# Connection environment

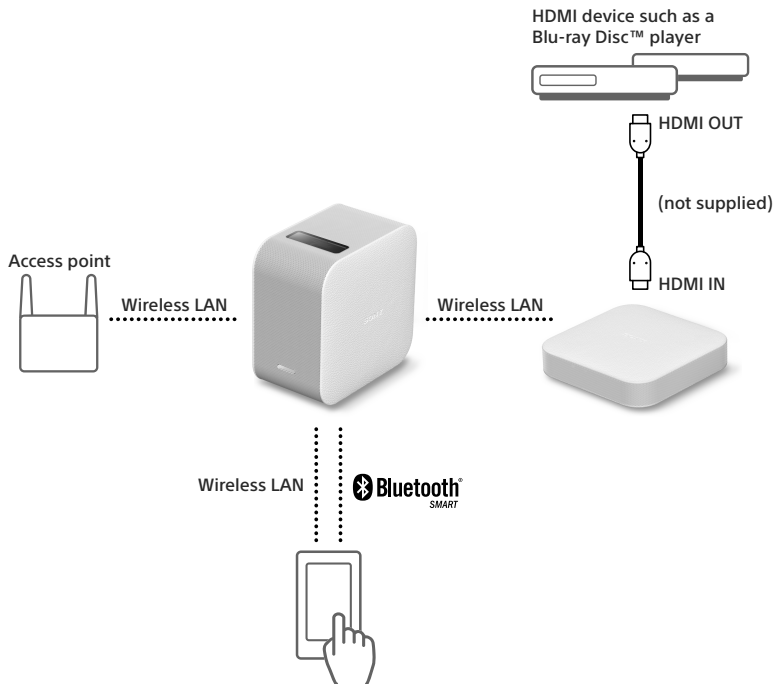

# 1 Checking contents



Wireless Unit



Portable Ultra Short Throw Projector  
(rechargeable built-in battery)

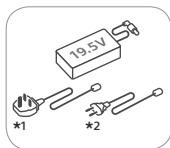

AC Adaptor (19.5 V)

\*1 For the UK and Ireland  
\*2 For other regions/countries

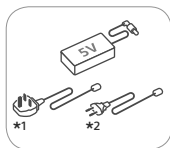

AC Adaptor (5 V)

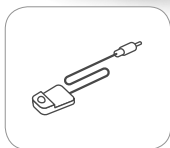

IR Blaster

Refer to the "Help Guide"  
for how to use.

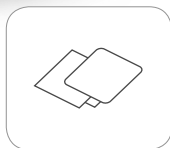

Startup Guide  
(this document)  
Reference Guide  
Warranty

## Other necessary items

- Smartphone
- HDMI cable  
Used to connect the Wireless Unit with an HDMI device such as a Blu-ray Disc player.

## Charging the projector

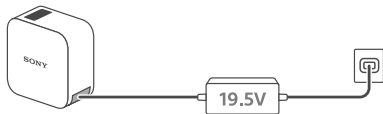

## 2 Turning the power on

### Project onto a wall

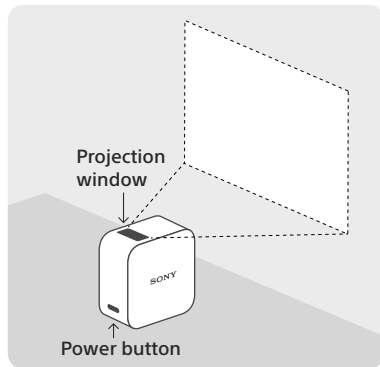

### Project onto a table or floor

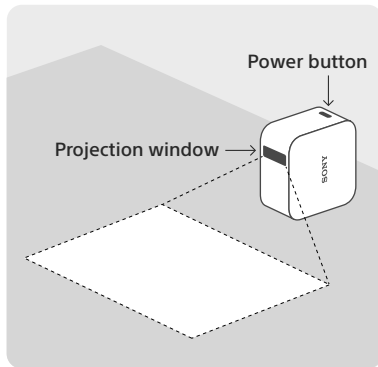

To turn the power on/off, press and hold the power button.

### How to connect an HDMI device

Connect the HDMI device to the HDMI IN connector of the Wireless Unit. For details on how to connect and use, refer to the "Help Guide" (see page 8).

# 3 Setting up with the app

Install the dedicated app “Portable Ultra Short Throw Projector Application” to a smartphone, then open it. Search for the app with the app name or scan the matrix code below to install the app. Follow the on-screen instructions to set up the unit.



<http://www.sony.net/lsp-x-p1/store/>



## Help Guide (Web operating instructions)

The "Help Guide" is the operating instructions provided on the Internet. It describes the features of the unit, how to use the unit in detail, and how to troubleshoot.

Visit the following site with your smartphone or computer.

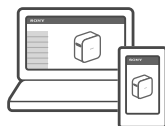

**[http://rd1.sony.net/help/projector/lspxp1/h\\_ec/](http://rd1.sony.net/help/projector/lspxp1/h_ec/)**







# Environnement de connexion

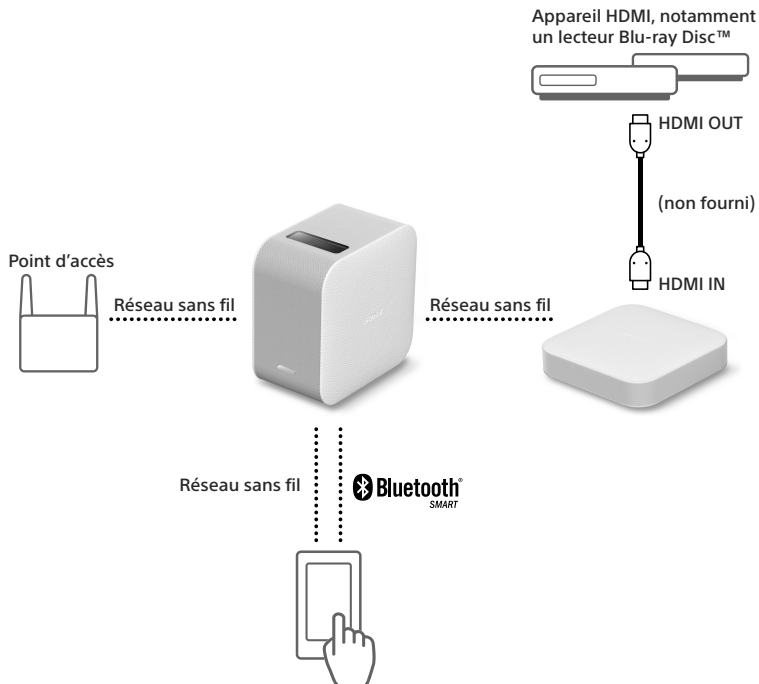

# 1 Vérification du contenu



Unité sans fil



Projecteur Ultra Courte Focale Portable (batterie rechargeable intégrée)

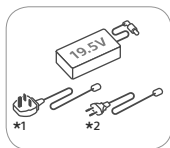

Adaptateur secteur (19,5 V)

\*1 Pour le Royaume-Uni et l'Irlande  
\*2 Pour les autres régions/pays

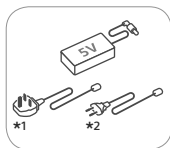

Adaptateur secteur (5 V)

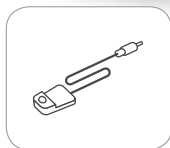

IR Blaster

Reportez-vous au « Guide d'aide » pour plus d'informations sur son utilisation.

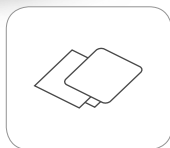

Guide de démarrage

(le présent document)  
Guide de référence Garantie

## Autres équipements nécessaires

- Smartphone
- Câble HDMI

Permet de connecter l'unité sans fil à un appareil HDMI, notamment un lecteur Blu-ray Disc.

## Chargement du projecteur

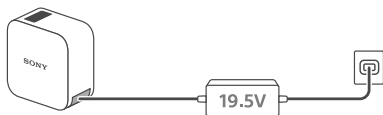

## 2 Mise sous tension

### Projection sur un mur

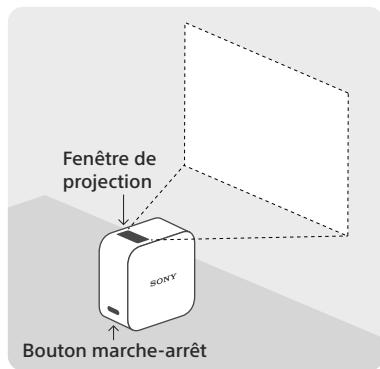

### Projection sur une table ou sur le sol

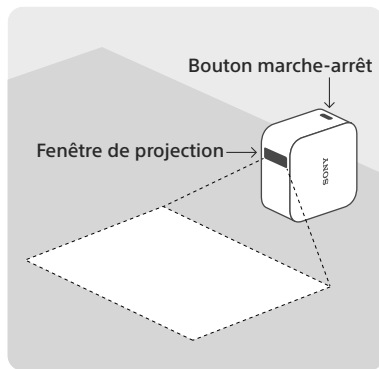

Pour mettre sous/hors tension, appuyez sur le bouton marche-arrêt et maintenez-le enfoncé.

### Comment connecter un appareil HDMI

Connectez l'appareil HDMI au connecteur HDMI IN de l'unité sans fil. Pour plus d'informations sur la connexion et l'utilisation, reportez-vous au « Guide d'aide » (voir page 14).

# 3 Configuration de l'application

Installez l'application dédiée « Application de Projecteur Ultra Courte Focale Portable » sur un smartphone, puis ouvrez-la. Recherchez l'application par son nom ou numérisez le code matriciel ci-dessous pour installer l'application. Configurez l'appareil en suivant les instructions affichées.



<http://www.sony.net/lsp-x-p1/store/>



## Guide d'aide (mode d'emploi Web)

Le « Guide d'aide » correspond au mode d'emploi disponible sur Internet. Il décrit les fonctions de l'appareil, son utilisation détaillée et la manière de le dépanner.

Visitez le site ci-dessous à partir de votre smartphone ou de votre ordinateur.

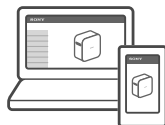

**[http://rd1.sony.net/help/projector/lspxp1/h\\_ec/](http://rd1.sony.net/help/projector/lspxp1/h_ec/)**





# Anschlussumgebung

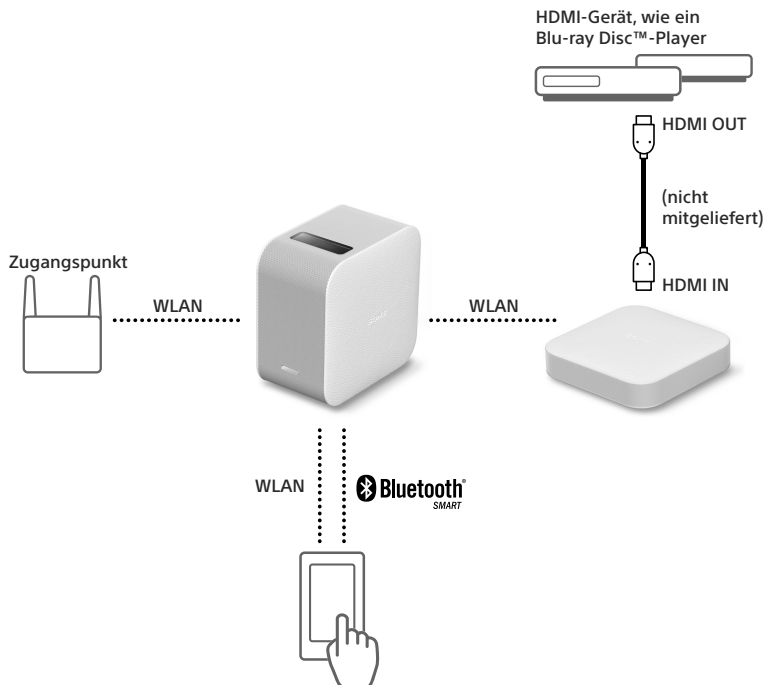



# 1 Überprüfen des Lieferumfangs



Drahtloses Modul



Portabler  
Ultrakurzstanzprojektor  
(integrierter Akku)

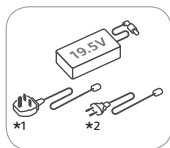

Netzteil (19,5 V)

\*1 Für GB und Irland

\*2 Für andere Regionen/Länder

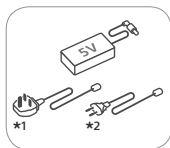

Netzteil (5 V)

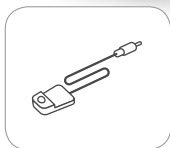

IR Blaster

Informationen zur  
Verwendung finden Sie in  
der „Hilfe“.

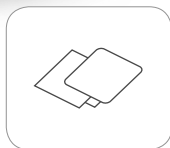

Einführungsanleitung  
(dieses Dokument)  
Referenzanleitung  
Garantie

## Sonstige erforderliche Gegenstände

- Smartphone
- HDMI-Kabel

Für die Verbindung des drahtlosen  
Moduls mit einem HDMI-Gerät, wie  
einem Blu-ray Disc-Player.

## Aufladen des Projektors

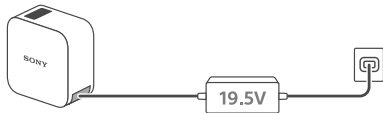

## 2 Einschalten

### Projektion auf eine Wand

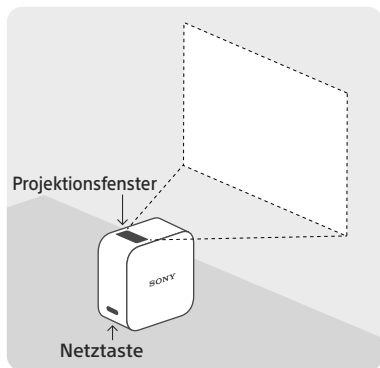

### Projektion auf einen Tisch oder den Boden

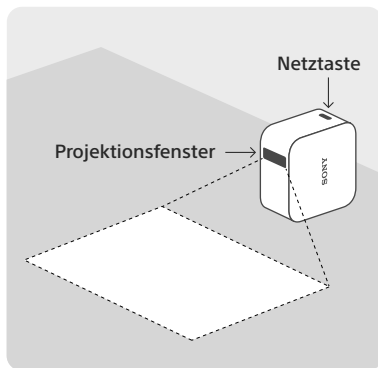

Um das Gerät ein-/auszuschalten, halten Sie die Netztaaste gedrückt.

### So schließen Sie ein HDMI-Gerät an

Verbinden Sie das HDMI-Gerät mit dem Anschluss HDMI IN des drahtlosen Moduls. Ausführliche Informationen zum Anschluss und zur Verwendung finden Sie in der „Hilfe“ (siehe Seite 20).

# 3 Einrichten mit der App

Installieren Sie die spezielle App „App für Portabler Ultrakurzstanzprojektor“ auf einem Smartphone und öffnen Sie sie dann.

Suchen Sie über den Namen nach der App oder scannen Sie den QR-Code unten, um die App zu installieren.

Befolgen Sie die Anweisungen auf dem Bildschirm, um das Gerät einzurichten.



<http://www.sony.net/lsp-x-p1/store/>



## Hilfe (Bedienungsanleitung im Internet)

Die „Hilfe“ ist die Bedienungsanleitung, die im Internet zur Verfügung steht. Sie beschreibt die Funktionen des Geräts, wie das Gerät genau verwendet wird und was bei Problemen zu tun ist. Besuchen Sie die folgende Website mit Ihrem Smartphone oder Computer.

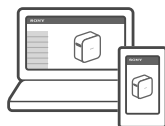

**[http://rd1.sony.net/help/projector/lspxp1/h\\_ec/](http://rd1.sony.net/help/projector/lspxp1/h_ec/)**





# Entorno de conexión

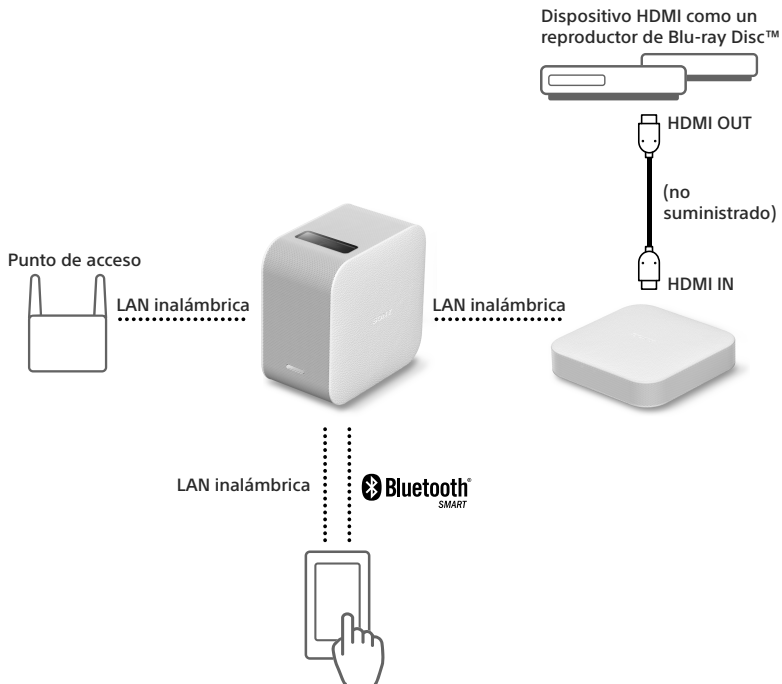

# 1 Comprobación de contenidos



Unidad Wireless



Proyector portátil de ultra corta distancia (batería integrada recargable)

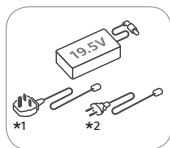

Adaptador de CA  
(19,5 V)

\*1 Para Reino Unido e Irlanda  
\*2 Para las demás regiones/países

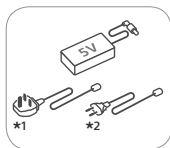

Adaptador de CA  
(5 V)

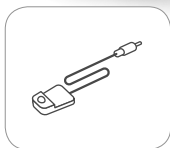

IR Blaster

Consulte la "Guía de ayuda" para ver instrucciones de utilización.

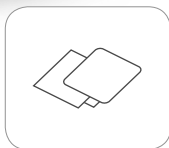

Guía de inicio  
(este documento)  
Guía de referencia  
Garantía

## Otros elementos necesarios

- Smartphone
- Cable HDMI

Utilizado para conectar la unidad Wireless con un dispositivo HDMI, como un reproductor de Blu-ray Disc.

## Carga del proyector

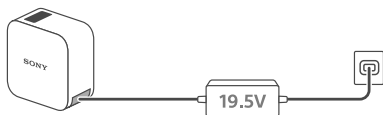

## 2 Encendido

### Proyección en una pared

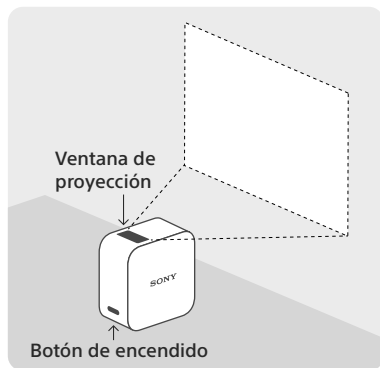

### Proyección en una mesa o en el suelo

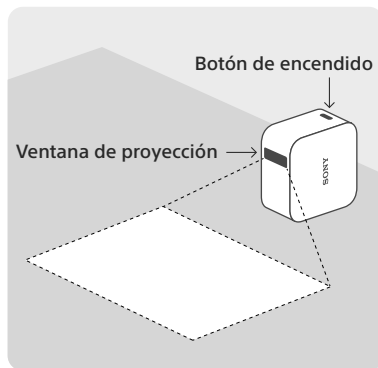

Para encender o apagar el dispositivo, mantenga pulsado el botón de encendido.

### Conexión de un dispositivo HDMI

Conecte el dispositivo HDMI al conector HDMI IN de la unidad Wireless. Para obtener más información sobre la conexión y la utilización, consulte la "Guía de ayuda" (ver página 26).



# 3 Configuración con la app

Instale la app especial “Aplicación del proyector portátil de ultra corta distancia” en un smartphone y ábrala.  
Busque la app a partir del nombre de la app o escanee el siguiente código para instalarla.  
Siga las instrucciones en pantalla para configurar la unidad.



<http://www.sony.net/lsp-x-p1/store/>



## Guía de ayuda (instrucciones web)

La “Guía de ayuda” es un manual de instrucciones disponible en Internet. Este documento describe las funciones de la unidad, sus instrucciones de utilización detalladas y consejos para la resolución de problemas.

Visite el siguiente sitio con su smartphone o su ordenador.

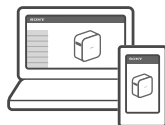

**[http://rd1.sony.net/help/projector/lspxp1/h\\_ec/](http://rd1.sony.net/help/projector/lspxp1/h_ec/)**





# Ambiente di connessione

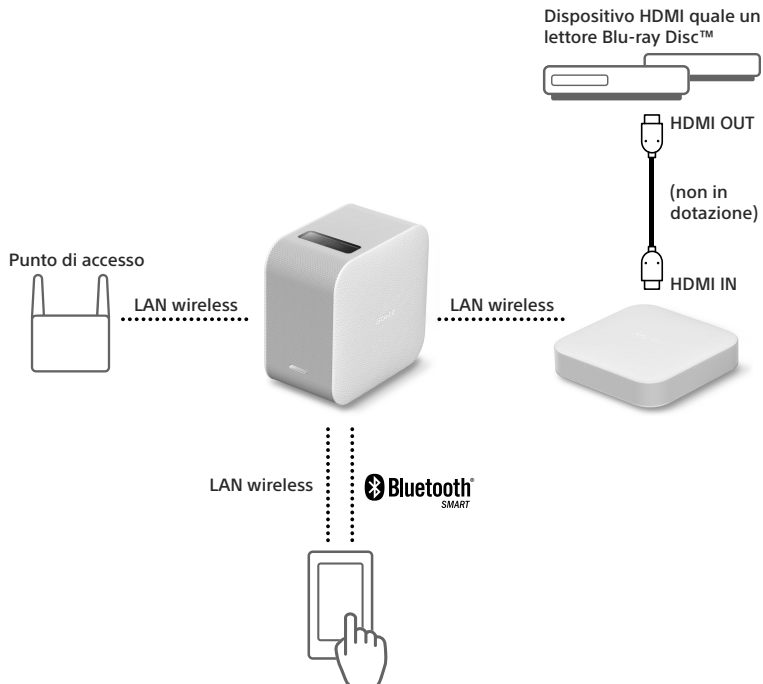

# 1 Controllo del contenuto



Trasmettitore Wireless



Proiettore portatile a ottica ultra corta (batteria ricaricabile incorporata)

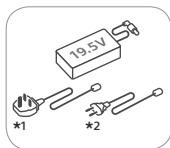

Adattatore CA  
(19,5 V)

\*1 Per Regno Unito e Irlanda  
\*2 Per altre regioni/paesi

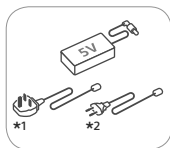

Adattatore CA (5 V)

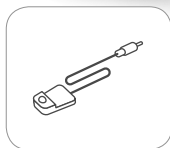

IR Blaster

Consultare la "Guida" per la modalità d'uso.

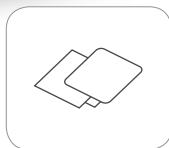

Guida di avvio  
(questo documento)  
Guida di riferimento  
Garanzia

## Altri articoli necessari

● Smartphone

● Cavo HDMI

Utilizzato per collegare il Trasmettitore Wireless a un dispositivo HDMI quale un lettore Blu-ray Disc.

## Caricamento del proiettore

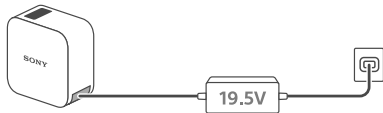

## 2 Accensione dell'alimentazione

### Proiezione su una parete

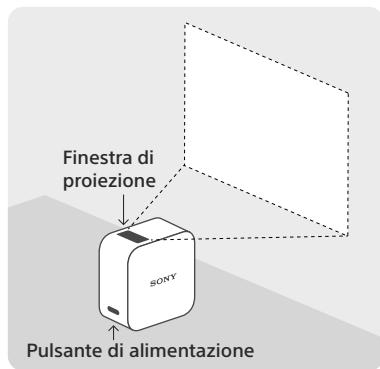

### Proiezione su un tavolo o sul pavimento

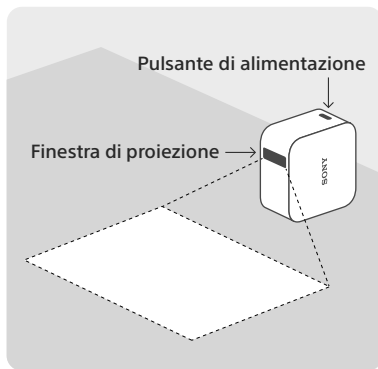

Per spegnere/accendere l'alimentazione, tenere premuto il pulsante di alimentazione.

### Come collegare un dispositivo HDMI

Collegare il dispositivo HDMI al Connettore HDMI IN del Trasmettitore Wireless. Per i dettagli su come collegarlo e utilizzarlo, consultare la "Guida" (vedere pagina 32).

### 3 Configurazione con la app

Installare la app dedicata "Applicazione per un proiettore portatile a ottica ultra corta" in uno smartphone, quindi aprirla.  
Cercare la app con il nome app oppure eseguire la scansione del codice della matrice qui di seguito per installare l'app.  
Seguire le istruzioni a schermo per configurare l'unità.



<http://www.sony.net/lsp-x-p1/store/>

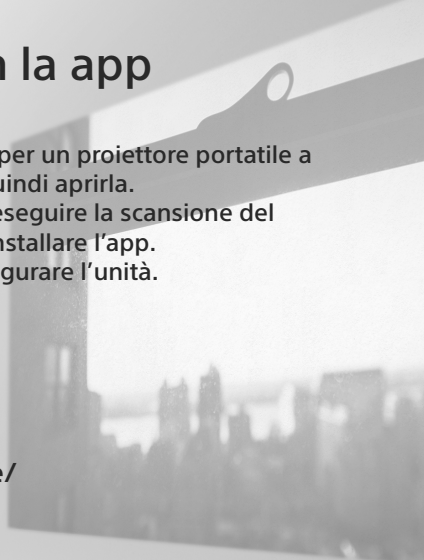

## Guida (Istruzioni di funzionamento da web)

La "Guida" è rappresentata dalle istruzioni di funzionamento fornite su Internet. Essa descrive le caratteristiche dell'unità, come utilizzare l'unità in dettaglio e come risolvere i problemi.

Visitare il seguente sito con lo smartphone o il computer.

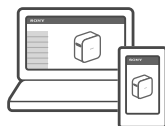

**[http://rd1.sony.net/help/projector/lspxp1/h\\_ec/](http://rd1.sony.net/help/projector/lspxp1/h_ec/)**







# Verbindingsomgeving

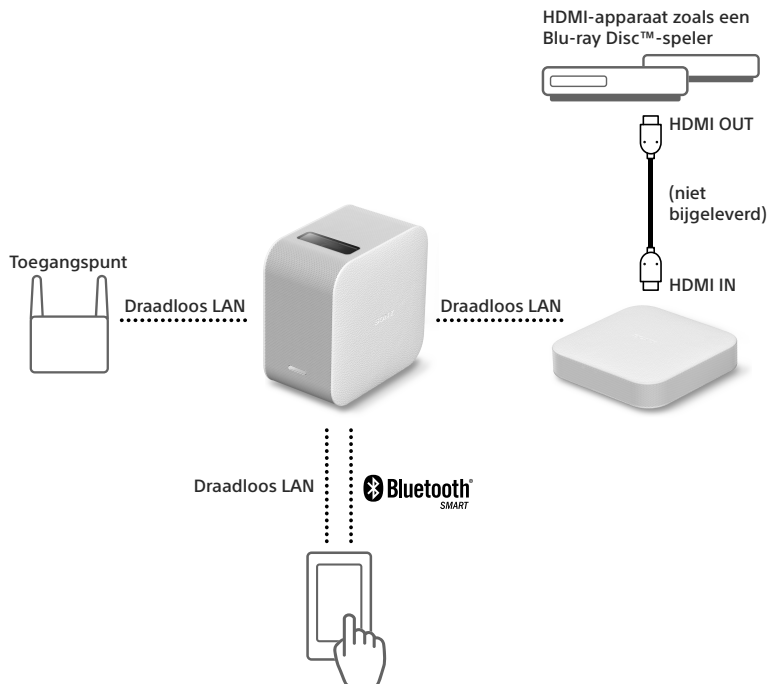

# 1 De inhoud controleren



Draadloos element



Draagbare Ultra Short Throw-projector (oplaadbare ingebouwde batterij)

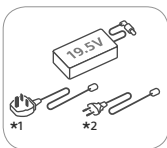

Netspanningsadapter (19,5 V)

\*1 Voor het VK en Ierland  
\*2 Voor andere regio's/landen

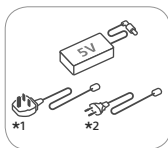

Netspanningsadapter (5 V)

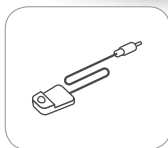

IR Blaster

Raadpleeg de "Helpgids" voor meer informatie over het gebruik.

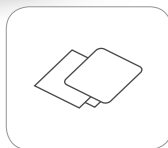

Beknopte gids (dit document)  
Referentiegids  
Garantie

## Andere benodigde items

- Smartphone
- HDMI-kabel

Wordt gebruikt om het draadloze element te verbinden met een HDMI-apparaat zoals een Blu-ray Disc-speler.

## De projector opladen

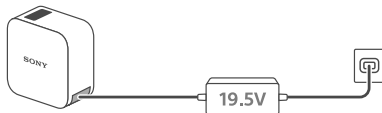

## 2 Het toestel inschakelen

### Projecteren op een muur

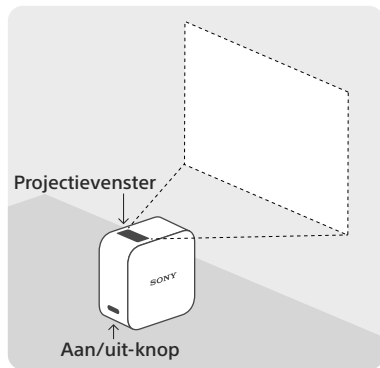

### Projecteren op een tafel of vloer

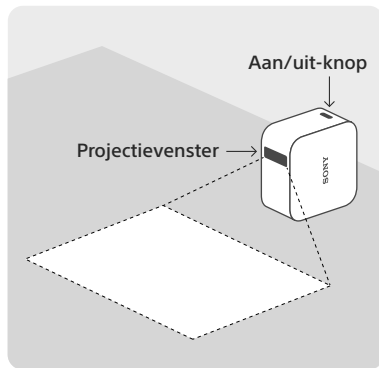

Om het toestel in of uit te schakelen, houdt u de aan/uit-knop ingedrukt.

### Een HDMI-apparaat aansluiten

Sluit het HDMI-apparaat aan op de HDMI IN-aansluiting van het draadloze element. Raadpleeg de "Helpgids" (zie pagina 38) voor meer informatie over de verbinding en het gebruik.

# 3 Configureren met behulp van de app

Installeer de app "Draagbare Ultra Short Throw-projectorapp" op een smartphone en open deze.  
Zoek de app aan de hand van de appnaam of scan de onderstaande matrixcode om de app te installeren.  
Volg de instructies op het scherm om het toestel te configureren.



<http://www.sony.net/lsp-x-p1/store/>



## Helpgids (webgebruiksaanwijzing)

De "Helpgids" is een gebruiksaanwijzing die via het internet geraadpleegd kan worden. U vindt er een beschrijving van de functies van het toestel, het gebruik ervan en het oplossen van problemen. Open de volgende site op uw smartphone of computer.

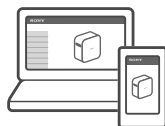

**[http://rd1.sony.net/help/projector/lspxp1/h\\_ec/](http://rd1.sony.net/help/projector/lspxp1/h_ec/)**





# Ambiente de ligação

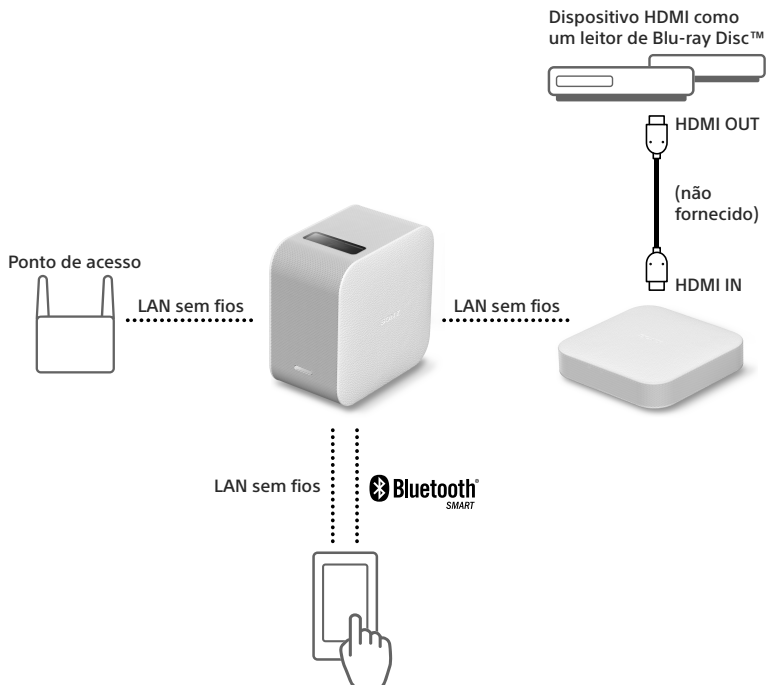



# 1 Verificar conteúdo



Unidade Wireless



Projektor portátil de ultra curta distancia (bateria integrada recarregável)

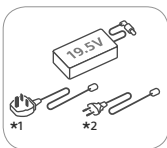

Transformador de CA (19,5 V)

\*1 Para o Reino Unido e Irlanda  
\*2 Para outras regiões/países

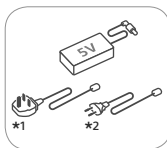

Transformador de CA (5 V)

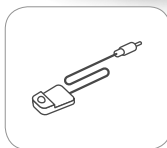

IR Blaster

Consulte o "Guia de ajuda" para saber como utilizar.

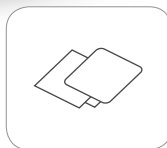

Guia de início (este documento)  
Guia de referência  
Garantia

## Outros itens necessários

- Smartphone
- Cabo HDMI  
Utilizado para ligar a Unidade Wireless a um dispositivo HDMI, como um leitor de Blu-ray Disc.

## Carregar o projetor

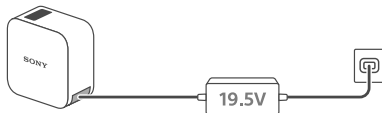

## 2 Ligar a alimentação

### Projetar numa parede

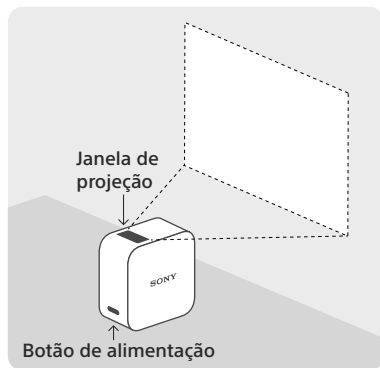

### Projetar numa mesa ou no chão

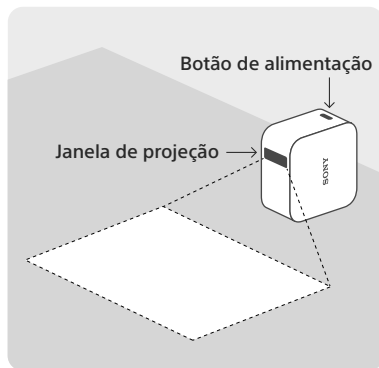

Para ligar/desligar a alimentação, carregue sem soltar no botão de alimentação.

### Como ligar um dispositivo HDMI

Ligue o dispositivo HDMI ao conector HDMI IN da Unidade Wireless. Para detalhes sobre como ligar e utilizar, consulte o "Guia de ajuda" (consulte a página 44).

# 3 Configurar com a aplicação

Instale a aplicação dedicada "Aplicação do projetor portátil de alcance ultra curto" num smartphone e, em seguida, abra-a. Pesquise a aplicação através do respetivo nome ou leia o código matriz abaixo para instalar a aplicação. Siga as instruções no ecrã para configurar a unidade.



<http://www.sony.net/lsp-x-p1/store/>



## Guia de ajuda (Instruções de operação web)

O “Guia de ajuda” são as instruções de operação fornecidas na internet. Descreve as funcionalidades da unidade, a forma de utilizar a unidade detalhadamente e a resolução de problemas.

Visite o seguinte site com o seu smartphone ou computador.

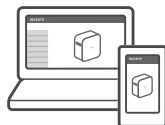

**[http://rd1.sony.net/help/projector/lspxp1/h\\_ec/](http://rd1.sony.net/help/projector/lspxp1/h_ec/)**





# Περιβάλλον σύνδεσης

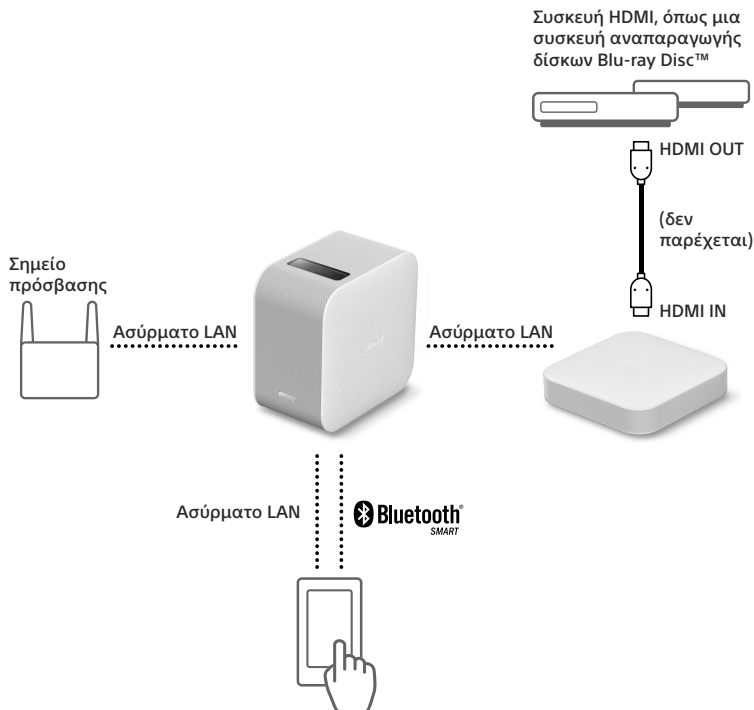

# 1 Έλεγχος των περιεχομένων



Ασύρματη μονάδα



Φορητός Προβολέας  
Εξαιρετικά Μικρής  
Εμβέλειας  
(ενσωματωμένη  
επαναφορτιζόμενη  
μπαταρία)

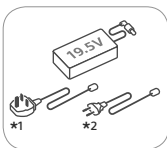

Μετασχηματιστής  
εναλλασσόμενου  
ρεύματος (19,5 V)

\*1 Για το Ηνωμένο Βασίλειο και την Ιρλανδία  
\*2 Για άλλες περιοχές/χώρες

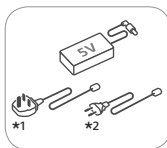

Μετασχηματιστής  
εναλλασσόμενου  
ρεύματος (5 V)

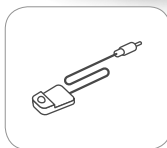

IR Blaster  
Ανατρέξτε στο εγχειρίδιο  
"Οδηγός βοήθειας" για  
τον τρόπο χρήσης.

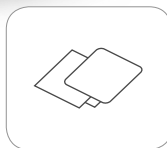

Οδηγός έναρξης  
(το παρόν  
εγχειρίδιο)  
Οδηγός αναφοράς  
Εγγύηση

## Άλλα απαραίτητα αντικείμενα

- Smartphone
- Καλώδιο HDMI

Χρησιμοποιείται για τη σύνδεση της Ασύρματης μονάδας με μια συσκευή HDMI, όπως μια συσκευή αναπαραγωγής δίσκων Blu-ray Disc.

## Φόρτιση του προβολέα

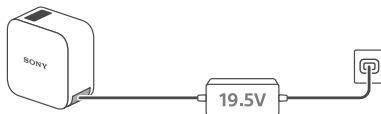

## 2 Ενεργοποίηση

### Προβολή σε τοίχο

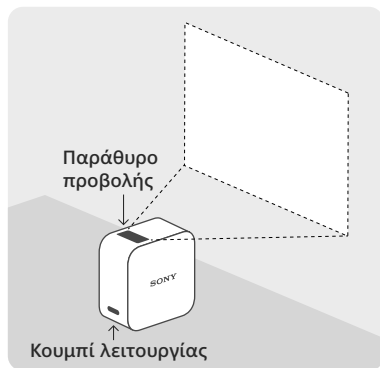

### Προβολή σε τραπέζι ή στο δάπεδο

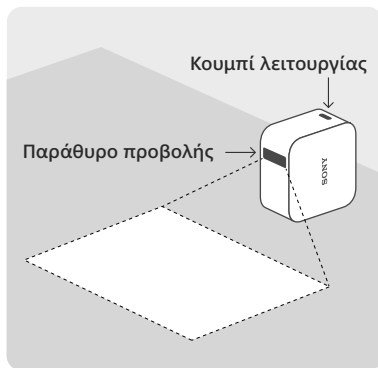

Για να ενεργοποιήσετε/απενεργοποιήσετε τη συσκευή, πιέστε παρατεταμένα το κουμπί λειτουργίας.

### Πώς να συνδέσετε μια συσκευή HDMI

Συνδέστε τη συσκευή HDMI στην υποδοχή HDMI IN της Ασύρματης μονάδας. Για λεπτομέρειες σχετικά με τον τρόπο σύνδεσης και χρήσης, ανατρέξτε στο εγχειρίδιο "Οδηγός βοήθειας" (βλ. σελίδα 50).



# 3 Ρύθμιση με την εφαρμογή

Εγκαταστήστε την ειδική "Εφαρμογή για φορητό προβολέα εξαιρετικά μικρής εμβέλειας" σε ένα smartphone και, στη συνέχεια, ανοίξτε την.

Αναζητήστε την εφαρμογή με το όνομά της ή σαρώστε τον παρακάτω κώδικα πλέγματος, για να εγκαταστήσετε την εφαρμογή.

Ακολουθήστε τις οδηγίες στην οθόνη για να εγκαταστήσετε τη μονάδα.



<http://www.sony.net/lsp-x-p1/store/>



## Οδηγός βοήθειας (οδηγίες λειτουργίας στο web)

Ο "Οδηγός βοήθειας" είναι οι οδηγίες λειτουργίας που παρέχονται στο Internet. Περιγράφει τις δυνατότητες της μονάδας, τον τρόπο χρήσης της μονάδας με λεπτομέρειες και τον τρόπο αντιμετώπισης προβλημάτων. Επισκεφτείτε την ακόλουθη τοποθεσία χρησιμοποιώντας το smartphone ή τον υπολογιστή σας.

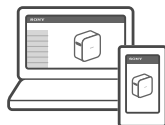

**[http://rd1.sony.net/help/projector/lspxp1/h\\_ec/](http://rd1.sony.net/help/projector/lspxp1/h_ec/)**





# Środowisko połączenia

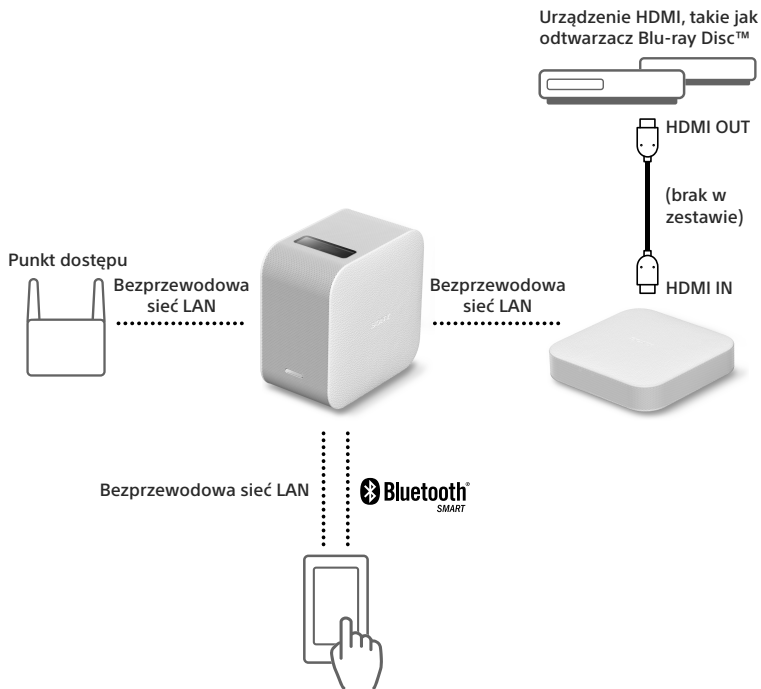

# 1 Sprawdzanie zawartości opakowania



Urządzenie bezprzewodowe



Przenośny projektor do wyświetlania z bardzo małej odległości (wbudowany akumulator)

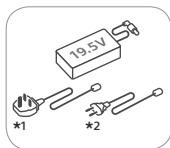

Zasilacz sieciowy (19,5 V)

\*1 Dla Wielkiej Brytanii i Irlandii  
\*2 Dla innych regionów/krajów

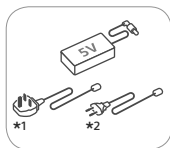

Zasilacz sieciowy (5 V)

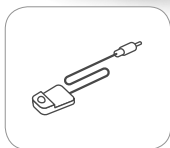

IR Blaster

Sposób użycia przedstawia „Przewodnik pomocniczy”.

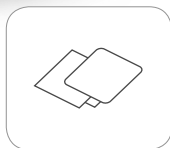

Przewodnik uruchamiania (ten dokument)  
Przewodnik Gwarancja

## Inne niezbędne elementy

- Smartfon
- Przewód HDMI

Służy do połączenia urządzenia bezprzewodowego z urządzeniem HDMI, takim jak odtwarzacz Blu-ray Disc.

## Ładowanie projektora

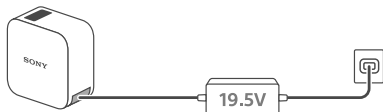

## 2 Włączanie zasilania

### Projekcja na ścianie

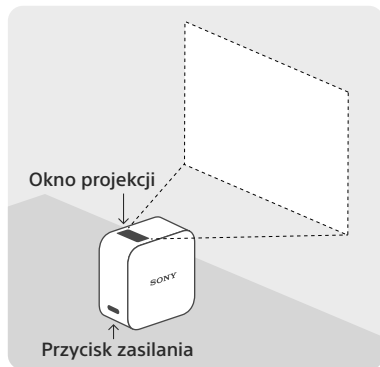

### Projekcja na stole lub podłodze

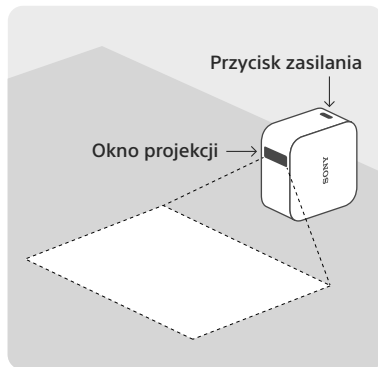

Aby włączyć lub wyłączyć zasilanie, naciśnij i przytrzymaj przycisk zasilania.

### Sposób podłączenia urządzenia HDMI

Podłącz urządzenie HDMI do złącza HDMI IN urządzenia bezprzewodowego. Szczegółowe informacje na temat sposobu podłączenia i użycia zawiera „Przewodnik pomocniczy” (patrz str. 56).

# 3 Konfigurowanie przy użyciu aplikacji

Zainstaluj na smartfonie dedykowaną aplikację „Aplikacja Przenośny Projektor do wyświetlania z bardzo małej odległości”, a następnie ją otwórz.

Wyszukaj aplikację przy użyciu jej nazwy lub zeskanuj poniższy kod w celu zainstalowania aplikacji.

Postępuj zgodnie z instrukcjami wyświetlanymi na ekranie w celu skonfigurowania urządzenia.



<http://www.sony.net/lsp-x-p1/store/>



## Przewodnik pomocniczy (internetowa instrukcja obsługi)

„Przewodnik pomocniczy” to instrukcja obsługi, która jest dostępna w Internecie. Opisuje funkcje urządzenia, sposób jego obsługi oraz sposób rozwiązywania problemów. Odwiedź następującą stronę internetową na smartfonie lub komputerze.

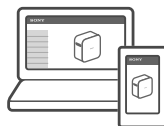

[http://rd1.sony.net/help/projector/lspxp1/h\\_ec/](http://rd1.sony.net/help/projector/lspxp1/h_ec/)







# Prostředí pro připojení

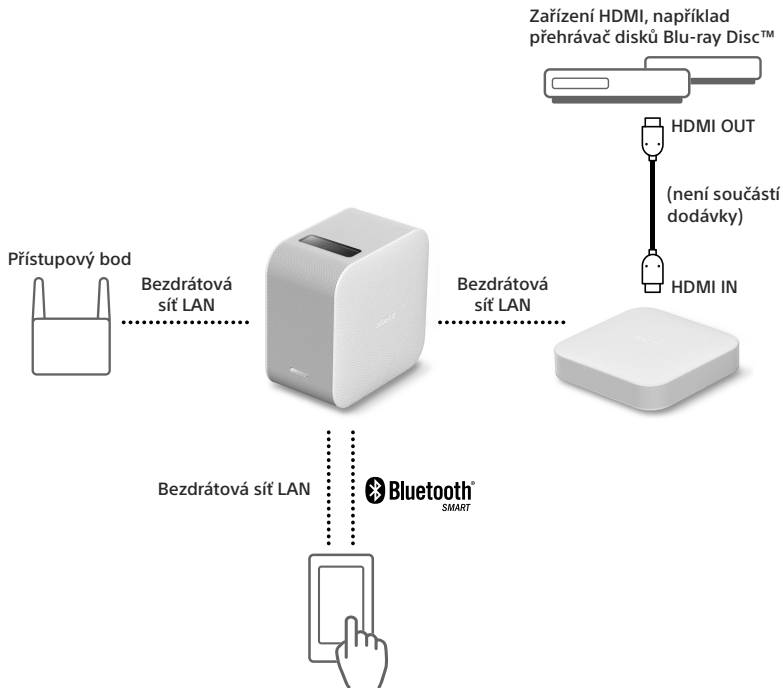

# 1 Kontrola obsahu



Bezdrátová jednotka



Přenosný projektor s velice krátkou projekční vzdáleností (dobíjecí vestavěná baterie)

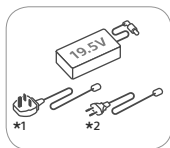

Síťový adaptér  
(19,5 V)

\*1 Pro Velkou Británii a Irsko  
\*2 Pro ostatní oblasti/země

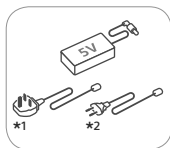

Síťový adaptér (5 V)

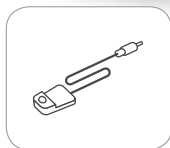

IR Blaster

Informace o způsobu použití naleznete v dokumentu „Uživatelská příručka“.

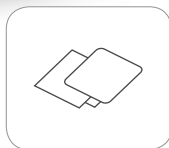

Počáteční instrukce  
(tento dokument)  
Referenční příručka  
Žárka

## Ostatní nezbytné položky

- Chytrý telefon
- Kabel HDMI

Slouží k připojení bezdrátové jednotky k zařízení HDMI, jako je například přehrávač disků Blu-ray Disc.

## Nabíjení projektoru

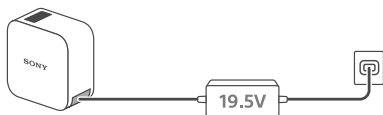

## 2 Zapnutí napájení

### Promítání na zeď

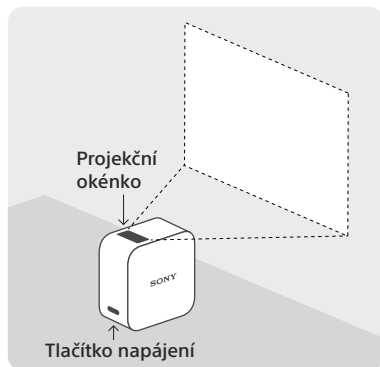

### Promítání na stůl nebo na podlahu

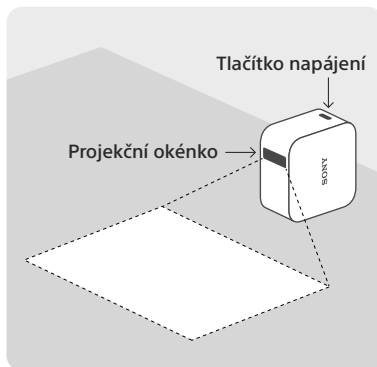

Napájení zapnete/vypnete stisknutím a přidržením tlačítka napájení.

### Připojení zařízení HDMI

Připojte zařízení HDMI ke konektoru HDMI IN bezdrátové jednotky. Podrobnosti o způsobu připojení a používání naleznete v dokumentu „Uživatelská příručka“ (viz stranu 62).

# 3 Nastavení pomocí aplikace

Nainstalujte si do chytrého telefonu specializovanou aplikaci „Aplikace pro přenosný projektor s velice krátkou projekční vzdáleností“, potom ji otevřete.

Abyste aplikaci nainstalovali, vyhledejte ji podle názvu aplikace nebo naskenujte maticový kód níže.

Nastavte zařízení podle pokynů na obrazovce.



<http://www.sony.net/lsp-x-p1/store/>



# Uživatelská příručka (návod k použití na internetu)

„Uživatelská příručka“ je návod k použití, který je dostupný na internetu. Popisuje funkce zařízení, podrobně se zabývá způsobem používání zařízení a řešením problémů.

Pomocí chytrého telefonu nebo počítače navštivte tyto stránky.

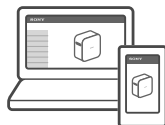

**[http://rd1.sony.net/help/projector/lspxp1/h\\_ec/](http://rd1.sony.net/help/projector/lspxp1/h_ec/)**





# Tilslutningsmiljø

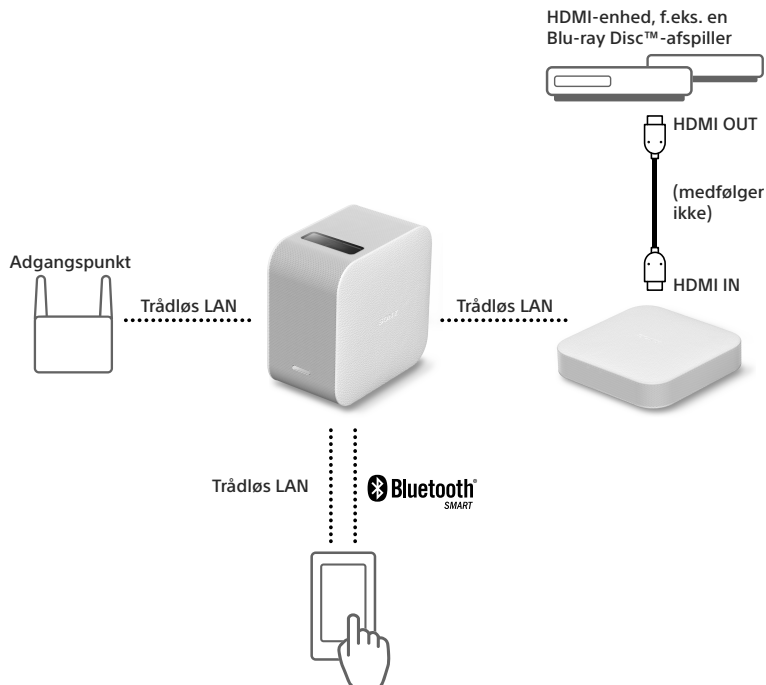



# 1 Kontrollerer indhold



Trådløs enhed



Bærbar Ultra Short Throw-projektor (genopladeligt indbygget batteri)

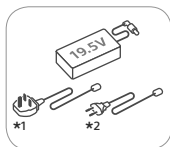

AC-adapter (19,5 V)

\*1 Til England og Irland  
\*2 Til andre regioner/lande

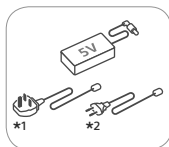

AC-adapter (5 V)

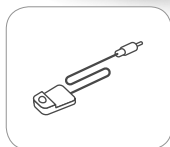

IR Blaster

Der henvises til "Hjælpevejledning" angående brug.

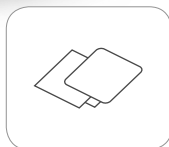

Startvejledning (dette dokument)  
Referencevejledning  
Garanti

## Andre nødvendige elementer

- Smartphone
- HDMI-kabel

Bruges til at slutte en trådløs enhed til en HDMI-enhed, f.eks. en Blu-ray Disc-afspiller.

## Opladning af projektor

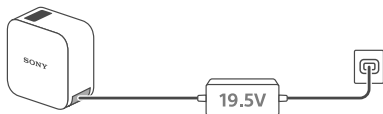

## 2 Sådan tændes der for strømmen

### Projicer på en væg

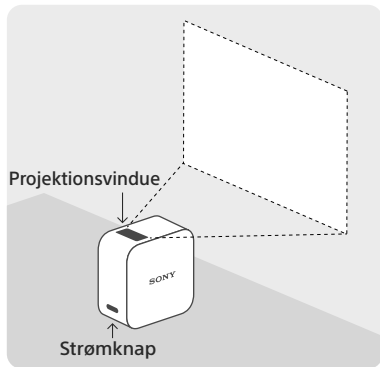

### Projicer på et bord eller gulv

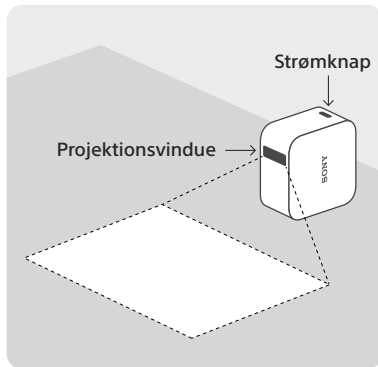

For at tænde/slukke, tryk og hold strømknappen nede.

### Sådan forbinder du en HDMI-anordning

Forbind HDMI-enheten til HDMI IN-stikket på den trådløse enhed. Oplysninger om forbindelse og brug fremgår af "Hjælpevejledning" (se side 68).

# 3 Opsætning med app'en

Installer den dedikerede app "Bærbar Ultra Short Throw-projektorapp" på en smartphone, og åbn den. Søg efter app'en ved hjælp af app-navn eller scan matrix-koden nedenfor for at installere app'en. Følg instruktionerne på skærmen for at opsætte enheden.



<http://www.sony.net/lsp-x-p1/store/>



## Hjælpevejledning (Web-driftsinstruktioner)

"Hjælpevejledning" er betjeningsvejledningen, der kan findes på internettet. Den beskriver funktionerne i enheden, hvordan du bruger enheden i detaljer, og hvordan du foretager fejlfinding.

Besøg følgende hjemmeside med din smartphone eller computer.

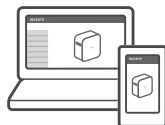

**[http://rd1.sony.net/help/projector/lspxp1/h\\_ec/](http://rd1.sony.net/help/projector/lspxp1/h_ec/)**





# Liitäntäympäristö

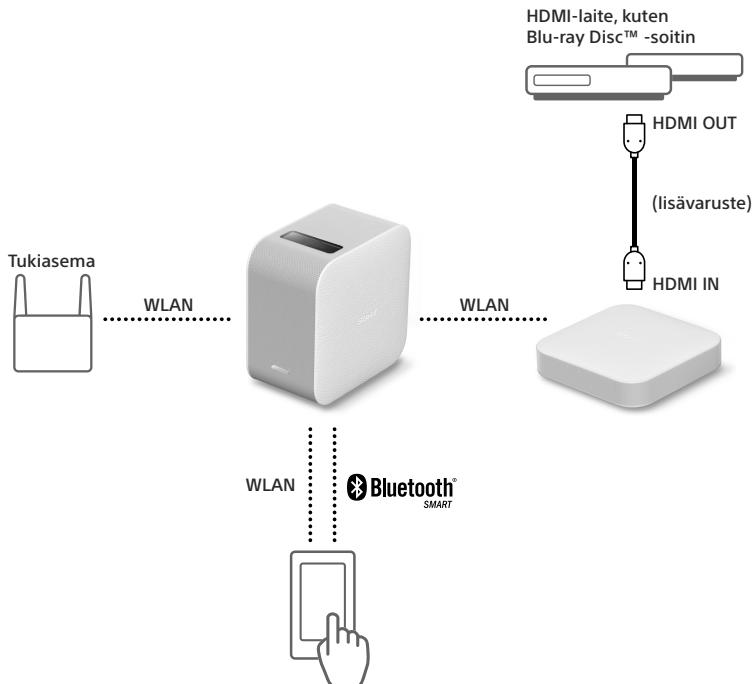

# 1 Sisällön tarkistaminen



Langaton yksikkö



Kannettava ultralyhyen heittotaman projektori (ladattava sisäinen akku)

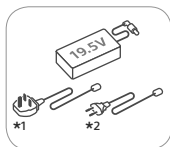

Verkkolaite (19,5 V)

\*1 Yhdistynyt kuningaskunta ja Irlanti  
\*2 Muut alueet/maat

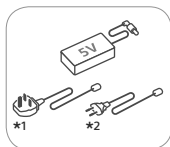

Verkkolaite (5 V)

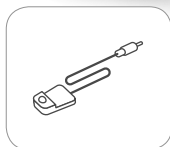

IR Blaster

Käyttäminen, katso "Käyttöopas".

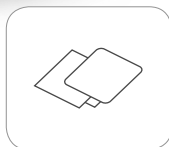

Aloituspapas (tämä asiakirja)  
Viiteopas  
Takuu

## Muut tarvittavat tuotteet

- Älypuhelin
- HDMI-kaapeli

Käytetään langattoman yksikön liittämiseen HDMI-laitteeseen, kuten Blu-ray Disc -soittimeen.

## Projektorin lataaminen

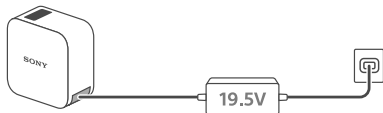

## 2 Virran kytkeminen

### Heijastaminen seinälle

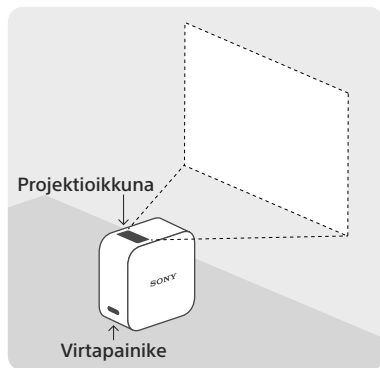

### Heijastaminen pöydälle tai lattialle

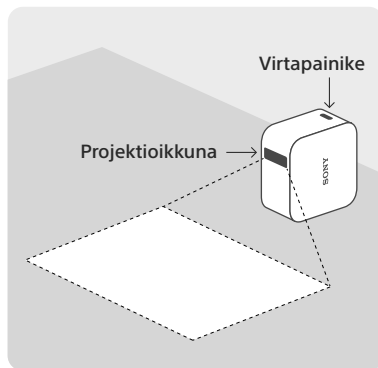

Virta kytketään päälle ja pois pitämällä virtapainiketta painettuna.

### Liittäminen HDMI-laitteeseen

Liitä HDMI-laite langattoman yksikön HDMI IN -liittimeen. Lisätietoja liittämisestä ja käytöstä, katso "Käyttöopas" (ks. sivu 74).



# 3 Asettaminen sovelluksen kanssa

Asenna "Kannettavan ultralyhyen heittomatkan projektorin sovellus" älypuhelimien ja avaa se.

Etsi sovellus sovelluksen nimellä tai skannaamalla alla oleva matriisikoodi sovelluksen asentamiseksi.

Tee laitteen asetukset noudattamalla näytön ohjeita.



<http://www.sony.net/lsp-x-p1/store/>



## Käyttöopas (Web-käyttöohjeet)

”Käyttöopas” on Internetissä käytettävissä oleva käyttöohje. Siinä kuvataan laitteen toiminnot, käyttö ja vianmääritys. Vieraile seuraavalla sivustolla älypuhelimellasi tai tietokoneellasi.

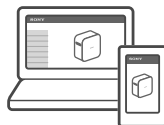

[http://rd1.sony.net/help/projector/lspxp1/h\\_ec/](http://rd1.sony.net/help/projector/lspxp1/h_ec/)





# Anslutningsmiljö

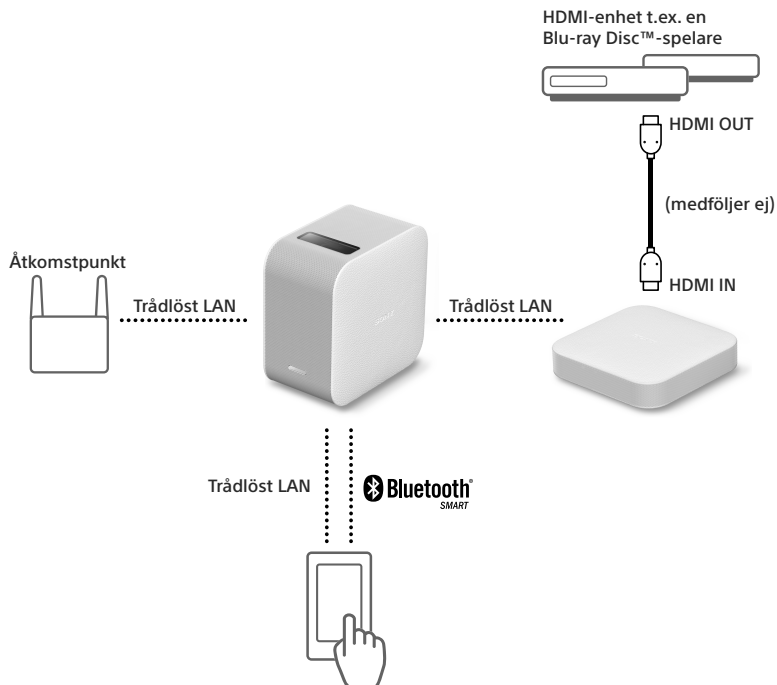

# 1 Kontrollera innehållet



Trådlös enhet



Bärbar kortdistansprojektor  
(laddningsbart inbyggt batteri)

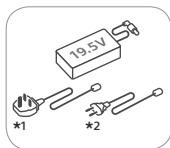

Nätadapter (19,5 V)

\*1 För Storbritannien och Irland  
\*2 För andra regioner/länder

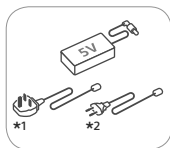

Nätadapter (5 V)

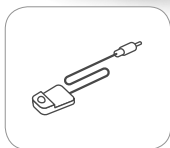

IR Blaster

Se "Hjälpguide" för tips  
om användning.

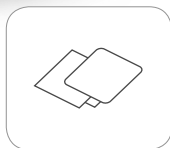

Startguide (det här  
dokumentet)  
Referensmaterial  
Garanti

## Andra föremål som krävs

- Smartphone
- HDMI-kabel

Används för att ansluta den trådlösa enheten till en HDMI-enhet t.ex. en Blu-ray Disc-spelare.

## Ladda projektorn

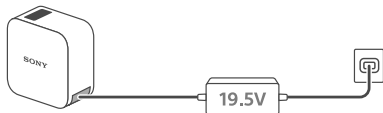

## 2 Slå på strömmen

Projicera på en vägg

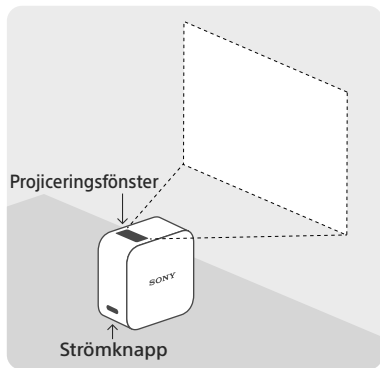

Projicera på ett bord eller ett golv

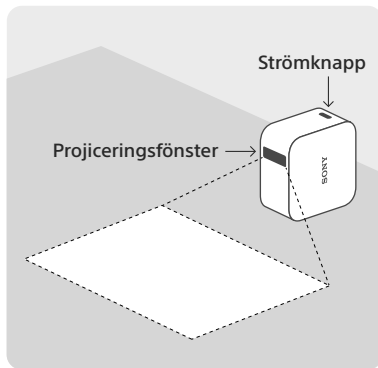

Tryck på och håll strömknappen intryckt för att slå på/stänga av strömmen.

### Ansluta en HDMI-enhet

Anslut HDMI-enheten till den trådlösa enhetens HDMI IN-anslutning. Se "Hjälpguide" för mer information om anslutning och användning (se sidan 80).

### 3 Ställa in med appen

Installera appen "Program till bärbar kortdistansprojektor" på en smartphone och öppna den sedan.

Sök efter appen via appnamnet eller skanna matriskoden nedan för att installera appen.

Följ anvisningarna på skärmen för att ställa in enheten.



<http://www.sony.net/lsp-x-p1/store/>



## Hjälpguide (Internetanvisningar)

"Hjälpguide" är användningsinstruktionerna som finns på Internet. Den beskriver enhetens funktioner, hur enheten ska användas mer detaljerat samt en felsökningsguide. Se följande webbplats på din smartphone eller dator.

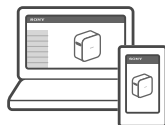

**[http://rd1.sony.net/help/projector/lspxp1/h\\_ec/](http://rd1.sony.net/help/projector/lspxp1/h_ec/)**







# Tilkoblingsmiljø

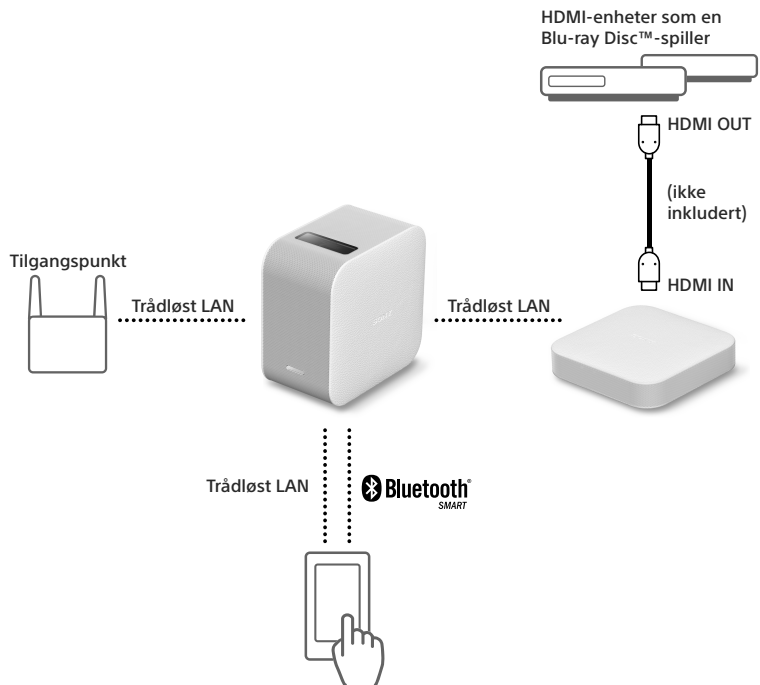

# 1 Kontrollere innholdet



Trådløs enhet



Bærbar projektor med svært kort bildeavstand (oppladbart, innebygd batteri)

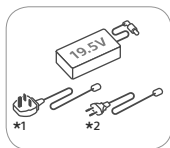

Strømadapter  
(19,5 V)

\*1 For Storbritannia og Irland  
\*2 For andre regioner/land

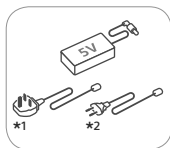

Strømadapter (5 V)

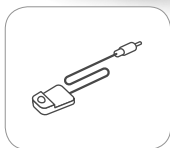

IR Blaster

Se "Hjelpeveiledning" for  
bruksanvisning.

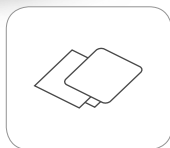

Startveiledning  
(dette dokumentet)  
Referanseveiledning  
Garanti

## Andre nødvendige elementer

- Smarttelefon
- HDMI-kabel

Brukes til å koble den trådløse enheten til med en HDMI-enhet som en Blu-ray Disc-spiller.

## Lade projektoren

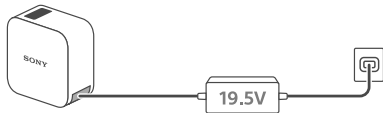

## 2 Slå på strømmen

Projisere på en vegg

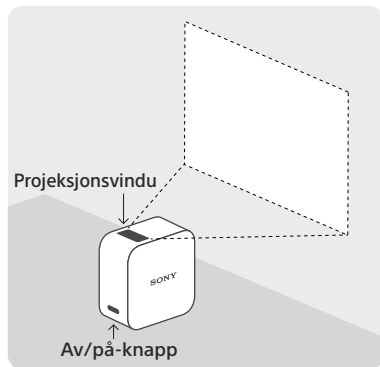

Projisere på et bord eller gulvet

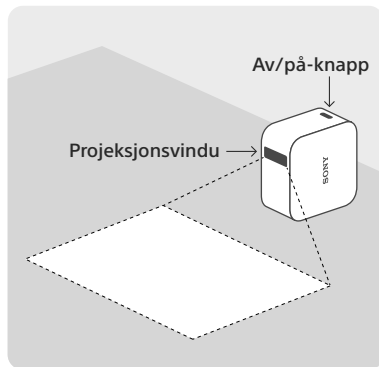

Trykk og hold av/på-knappen for å slå strømmen av/på.

### Slik kobler du til en HDMI-enhet

Koble HDMI-enheten til HDMI IN-kontakten på den trådløse enheten. For detaljer om hvordan du kobler til og bruker, se "Hjelpeveiledning" (se side 86).

# 3 Sette opp med appen

Installer den dedikerte "App til bærbar projektor med svært kort bildeavstand" på en smarttelefon og åpne den.

Søk etter appen med appnavnet eller skann koden under for å installere appen.

Følg anvisningene på skjermen for å sette opp enheten.



<http://www.sony.net/lsp-x-p1/store/>



## Hjelpeveiledning (nettbaserte anvisninger)

"Hjelpeveiledning" er bruksanvisningene som er tilgjengelige på Internett. Den beskriver funksjonene til enheten, detaljert informasjon om hvordan du bruker enheten samt hvordan du feilsøker.

Besøk følgende webside på smarttelefonen eller datamaskinen.

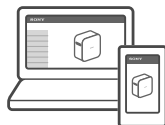

**[http://rd1.sony.net/help/projector/lspxp1/h\\_ec/](http://rd1.sony.net/help/projector/lspxp1/h_ec/)**





# Kapcsolati környezet

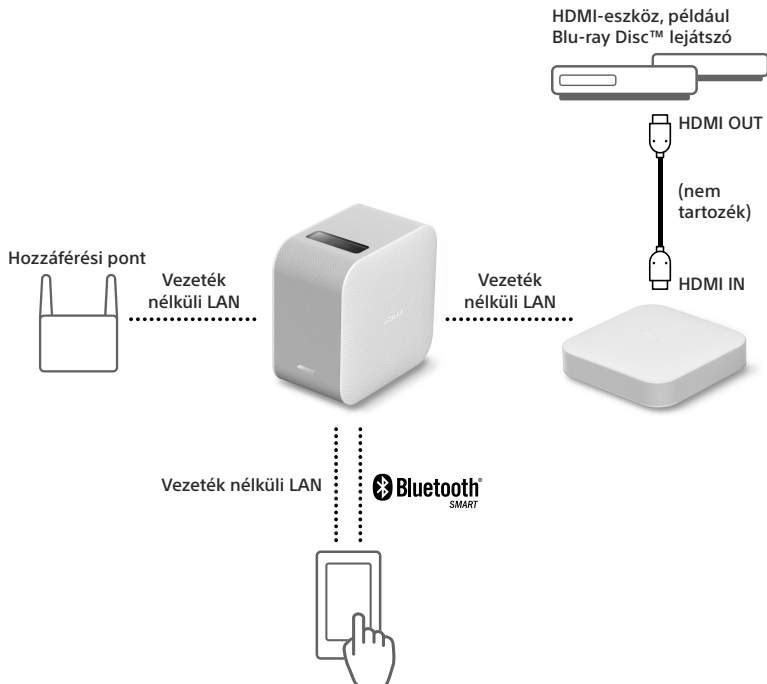



# 1 Tartalom ellenőrzése



Vezeték nélküli egység



Hordozható, ultra rövid vetítési távolságú projektor (újratölthető beépített akkumulátor)

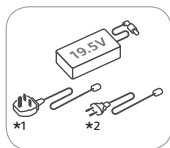

Hálózati tápegység (19,5 V)

\*1 Az Egyesült Királyság és Írország esetén  
\*2 Egyéb régiók/országok esetén

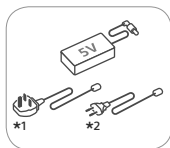

Hálózati tápegység (5 V)

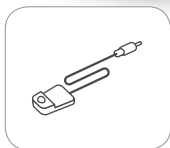

IR Blaster

A használathoz lásd: „Sugóútmutató”.

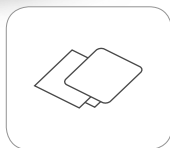

Használatbavételi útmutató (ez a dokumentum)  
Felhasználói útmutató  
Garancia

## Egyéb szükséges elemek

- Okostelefon
- HDMI-kábel

A vezeték nélküli egység HDMI-eszközhöz, például Blu-ray Disc lejátszóhoz végzett csatlakoztatására szolgál.

## A projektor töltése

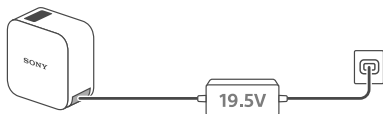

# 2 Bekapcsolás

## Vetítés falra

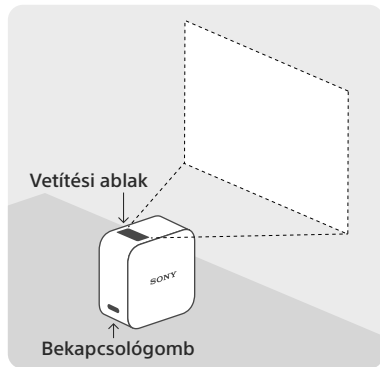

## Vetítés asztra vagy padlóra

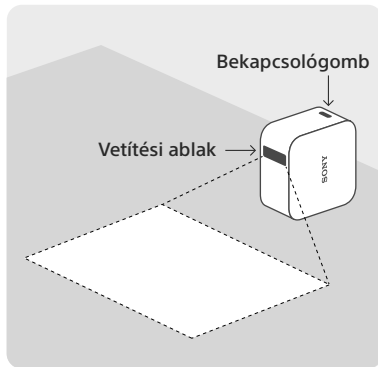

A be-/kikapcsoláshoz nyomja be és tartsa nyomva a bekapcsológombot.

## HDMI-eszköz csatlakoztatása

Csatlakoztassa a HDMI-eszközt a vezeték nélküli egység HDMI IN csatlakozójához. A csatlakoztatásról és a használatról részleteket a „Súgóútmutatóban” talál (lásd a 92. oldalt).

# 3 Beállítás az alkalmazással

Telepítse az erre a célra szolgáló „Hordozható, ultra rövid vetítési távolságú projektor alkalmazás”, majd nyissa meg azt. Keresse meg az alkalmazásnévvel rendelkező alkalmazást, vagy olvassa be az alábbi mátrixkódot az alkalmazás telepítéséhez. Az egység beállításához kövesse a képernyőn megjelenő utasításokat.



<http://www.sony.net/lsp-x-p1/store/>



## Súgóútmutató (webes használati útmutató)

A „Súgóútmutató” az interneten elérhető használati útmutató. Az egység jellemzőit, az egység részletes használatát és a hibaelhárítást írja le.

Látogasson el a következő webhelyre az okostelefonján vagy a számítógépén.

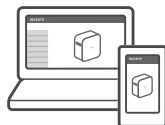

**[http://rd1.sony.net/help/projector/lspxp1/h\\_ec/](http://rd1.sony.net/help/projector/lspxp1/h_ec/)**





# Ühenduskeskkond

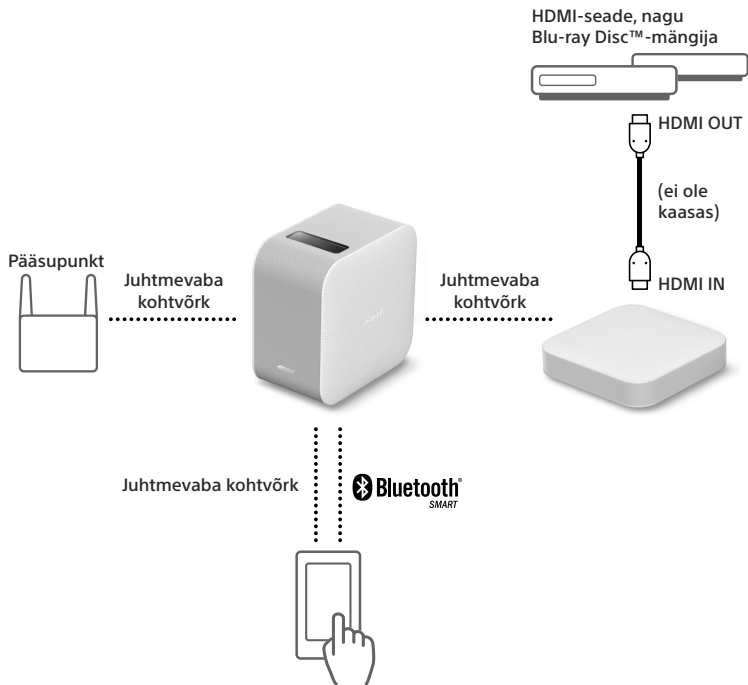

# 1 Pakendi sisu kontrollimine



Juhtmevaba seade



Kaasaskantav  
üülilähiprojektor  
(laetav  
integreeritud aku)

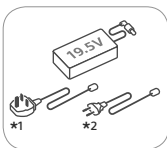

Vahelduvvooluadapter  
(19,5 V)

\*1 Ühendkuningriik ja liirima  
\*2 Muud piirkonnad/riigid

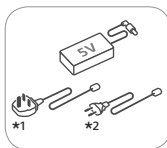

Vahelduvvooluadapter  
(5 V)

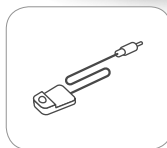

IR Blaster

Vaadake kasutamist  
„Spikker“.

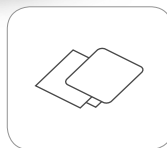

Kiirjuhend  
(see dokument)  
Teatmik  
Garantii

## Muud vajalikud esemed

- Nutitelefoni
- HDMI kaabel

Kasutatakse juhtmevaba seadme  
ühendamiseks HDMI-seadmega,  
nagu Blu-ray Disc-mängija.

## Projektori laadimine

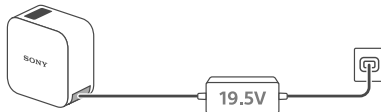

## 2 Toite sisse lülitamine

### Projitseerimine seinale

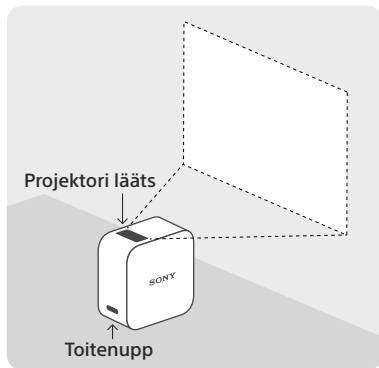

### Projitseerimine lauale või põrandale

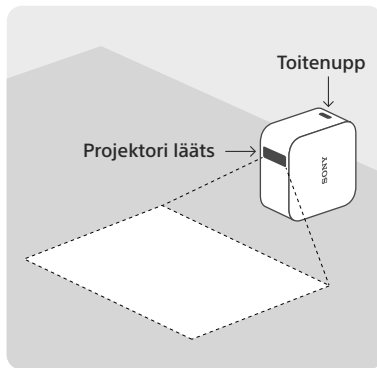

Toite sisse-välja lülitamiseks vajutage ja hoidke all toitenuppu.

### HDMI seadme ühendamine

Ühendage HDMI-seade juhtmevaba seadme pesaga HDMI IN. Ühendamise ja kasutamise üksikasju vaadake „Spikker” (vt lk 98).



### 3 Rakenduse seadistamine

Installige nutitelefoni spetsiaalne rakendus „Kaasaskantava üllilähiprojektori rakendus“, seejärel avage see. Otsige rakendust rakenduse nime järgi või skannige installimiseks allolev maatrikskood.

Seadme häälestamiseks järgige ekraanil kuvatavaid juhiseid.



<http://www.sony.net/lsp-x-p1/store/>



## Spikker (internetis olev kasutamisjuhend)

„Spikker“ on internetis olev kasutamisjuhend. See kirjeldab seadme omadusi, põhjalikumalt kasutamist ja rikkeotsingut. Küllastage nutitefonist või arvutist järgmist lehekülge.

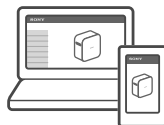

[http://rd1.sony.net/help/projector/lspxp1/h\\_ec/](http://rd1.sony.net/help/projector/lspxp1/h_ec/)





# Среда за свързване

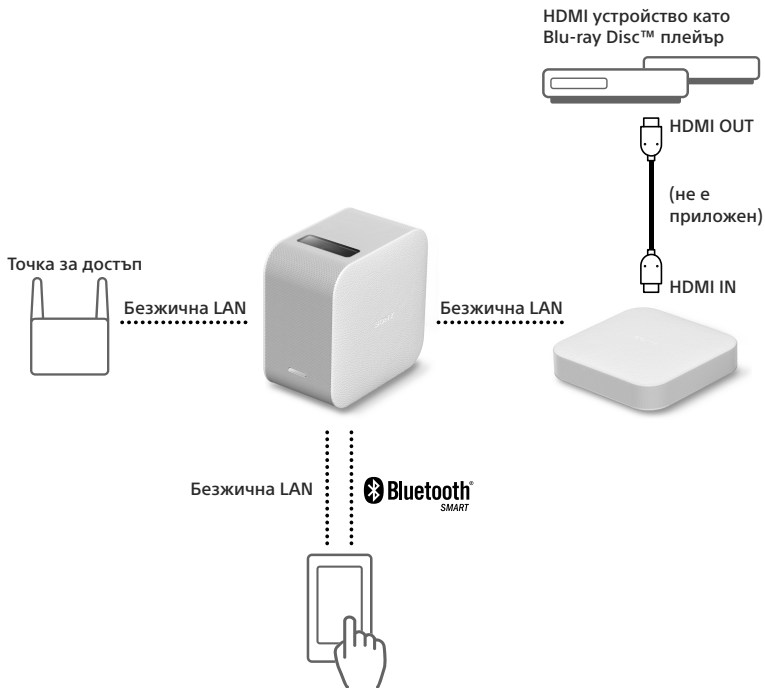

# 1 Проверка на съдържанието



Безжичен модул



Преносим проектор  
Ultra Short Throw  
(акумулаторна  
вградена батерия)

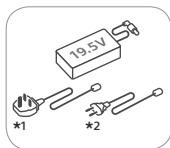

AC адаптер (19,5 V)

\*1 За Обединеното кралство и Ирландия

\*2 За други региони/държави

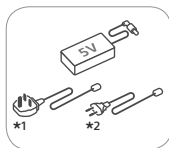

AC адаптер (5 V)

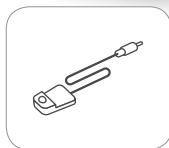

IR Blaster

Вижте "Помощно ръководство" относно начина на употреба.

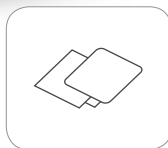

Кратко ръководство  
(този документ)  
Информация за  
продукта  
Гаранция

## Други необходими елементи

- Смартфон
- HDMI кабел

Използва се за свързване на безжичния модул с HDMI устройство, като например Blu-ray Disc плейър.

## Зареждане на проектора

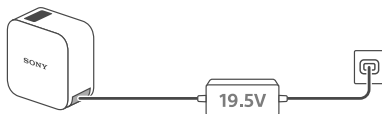

## 2 Включване на захранването

### Проектиране на стена

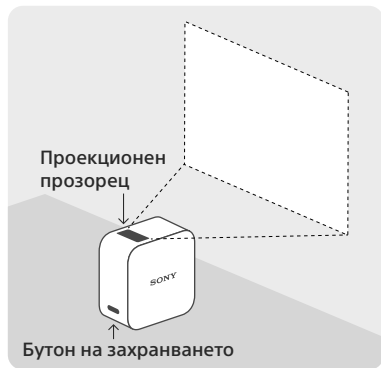

### Проектиране на маса или под

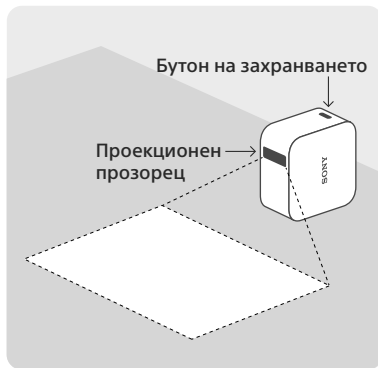

За да включите/изключите захранването, натиснете и задръжте бутона за захранването.

### Как да свържете HDMI устройство

Свържете HDMI устройството към конектора HDMI IN на безжичния модул. За подробности за свързване и работа вижте "Помощно ръководство" (вж. стр. 104).

# 3 Настройка чрез приложението

Инсталирайте специалното приложение “Приложение за преносим проектор Ultra Short Throw” на смартфон, след което го отворете.

Потърсете приложението чрез името на приложението или сканирайте матричния код по-долу, за да инсталирате приложението.

Следвайте инструкциите на екрана, за да настроите уреда.



<http://www.sony.net/lsp-x-p1/store/>



## Помощно ръководство (Инструкции за експлоатация в интернет)

“Помощно ръководство” представлява инструкции за експлоатация, предоставени в интернет. То описва функциите на уреда, подробности за използването му и начини за отстраняване на неизправности. Посетете следния сайт от вашия смартфон или компютър.

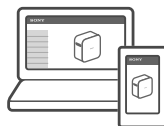

**[http://rd1.sony.net/help/projector/lspxp1/h\\_ec/](http://rd1.sony.net/help/projector/lspxp1/h_ec/)**







# Posibilități de conectare

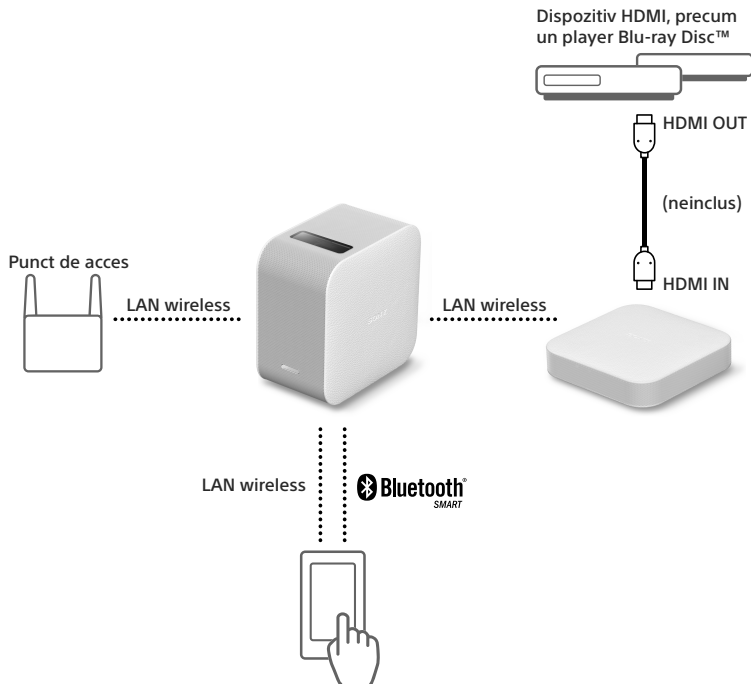

# 1 Verificarea conținutului



Unitate wireless



Proiector portabil  
Ultra Short Throw  
(baterie reîncărcabilă  
încorporată)

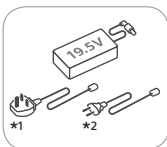

Adaptor de c.a.  
(19,5 V)

\*1 Pentru Marea Britanie și Irlanda  
\*2 Pentru alte regiuni/țări

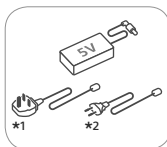

Adaptor de c.a. (5 V)

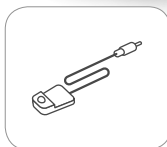

IR Blaster

Pentru modul de utilizare,  
consultați „Ghid de  
asistență”.

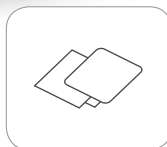

Ghid de inițiere  
(acest document)  
Ghid de referință  
Garanție

## Alte articole necesare

- Smartphone
- Cablu HDMI

Utilizat pentru a conecta unitatea wireless la un dispozitiv HDMI, precum un player Blu-ray Disc.

## Încărcarea proiecteurului

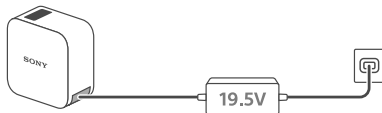

## 2 Pornirea

### Proiectarea pe un perete

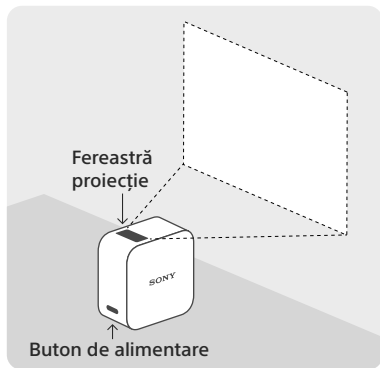

### Proiectarea pe o masă sau pe podea

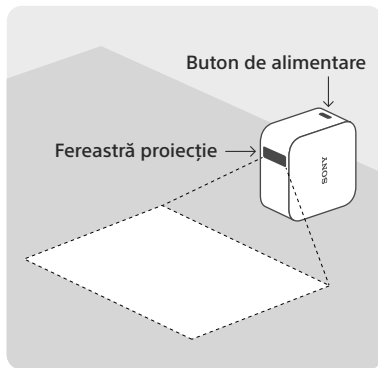

Pentru pornire/oprire, apăsați continuu butonul de alimentare.

### Modul de conectare a unui dispozitiv HDMI

Conectați dispozitivul HDMI la conectorul HDMI IN al unității wireless. Pentru detalii privind conectarea și utilizarea, consultați „Ghid de asistență” (vezi pagina 110).

### 3 Configurarea cu ajutorul unei aplicații

Instalați aplicația dedicată „Aplicație pentru proiector portabil Ultra Short Throw” pe un smartphone și lansați-o.  
Căutați aplicația după numele acesteia sau scanați codul QR de mai jos pentru a o instala.  
Urmați instrucțiunile de pe ecran pentru a configura unitatea.



<http://www.sony.net/lsp-x-p1/store/>



## Ghid de asistență (Instrucțiuni de utilizare pe web)

„Ghid de asistență” reprezintă instrucțiunile de utilizare oferite pe internet. Ghidul descrie caracteristicile unității, detaliile privind modul de utilizare și operațiunile de depanare. Vizitați următorul site de pe smartphone sau de pe computer.

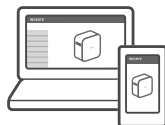

**[http://rd1.sony.net/help/projector/lspxp1/h\\_ec/](http://rd1.sony.net/help/projector/lspxp1/h_ec/)**

