

Other Operations

Searching content

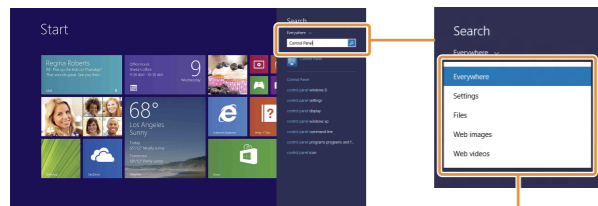

You can select the search target from the list.

- 1 Tap the **Search** charm (see cover).
 - 2 Enter a keyword (e.g. **Control Panel**) in the search box.
 - 3 Tap your preferred icon, app, etc. from the search result.
- You can also search from within certain apps, when available.

Entering sleep or shutting down

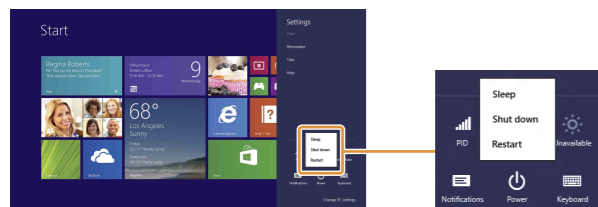

- 1 Tap the **Settings** charm (see cover).
- 2 Tap **Power**, then tap **Sleep**, **Shut down**, or **Restart**.

Switching apps

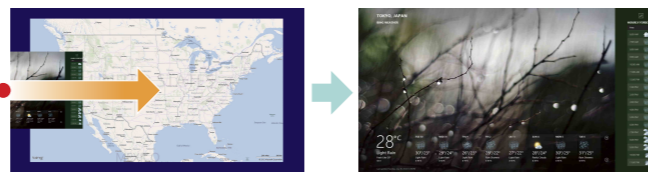

Swipe in from the left edge.

More about how to use Windows 8.1

Refer to **Windows Help and Support** or **Help+Tips**.

- 1 Swipe up on the **Start** screen to open the **Apps** screen.
- 2 Tap **Help and Support** or **Help+Tips** in the app list.

Screenshots in this guide are examples in English.
Content in this guide is subject to change without notice.

Windows and the Windows logo are either registered trademarks or trademarks of Microsoft Corporation in the United States and/or other countries. In the manual, the TM or (R) marks are not specified.



SONY®

Windows 8.1 Getting Started

New Start Screen and Menu

Start screen

You can add shortcuts to apps, the desktop, and websites that you use the most.

- **Touch operation**
Open the charms, then tap the **Start** charm.
- **With a keyboard**
Press the **Windows** key.



Charms

Search for apps and files, share content, play content on other devices or print, and set up your PC.

- **Touch operation**
Swipe in from the right edge.

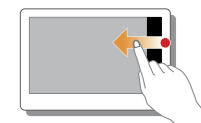

- **With a mouse/touch pad**
Point to the upper-right corner, then move downward.

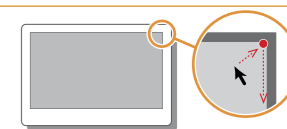

- **With a keyboard**
Press the **Windows** key and the **C** key at the same time.





Tiles

Tap a tile to start an app and personalize the **Start** screen by adding and rearranging tiles.

Using Apps

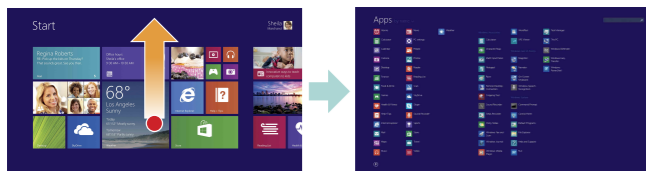
Opening the app list



- **Touch operation**
Swipe up on the **Start** screen.
- **With a mouse/touch pad**
Click the  icon at the lower-left of the **Start** screen.

The list of the apps installed on your VAIO computer is displayed.
You can pin the apps to the **Start** screen for easy access.

Viewing running apps

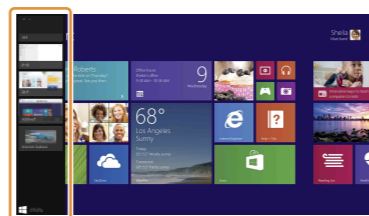

- **Touch operation**
Swipe in from the left edge until a small app icon appears, then drag the icon back towards the left edge.
- **With a mouse/touch pad**
Point to the upper-left corner, then move downward.



Opening the apps menu

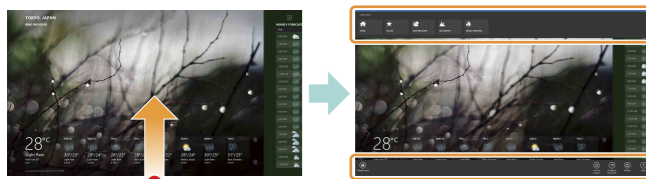

- **Touch operation**
Swipe up/down from the bottom/top edge.
- **With a mouse/touch pad**
Right-click within an app.

Closing apps

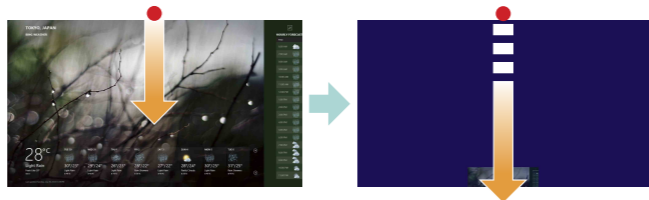



- 1 When an app is open, point to the top-center of the screen.
- 2 Drag the app to the bottom of the screen until the app disappears from the screen.

Using the Internet

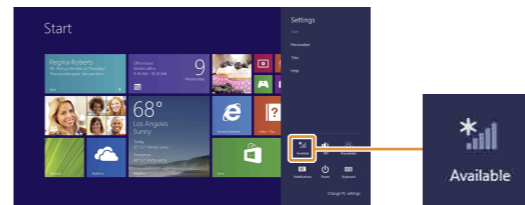
Connecting to Wi-Fi® (Wireless LAN)



- 1 Tap the  **Settings** charm (see cover).
- 2 Tap  (the network icon).
- 3 Select your wireless network from the list, then tap **Connect**.

Opening websites

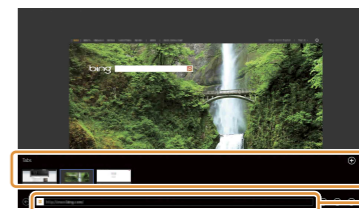

- 1 On the **Start** screen, tap the **Internet Explorer** tile.
- 2 Enter a URL or keyword to search websites.
- 3 To open a new tab, swipe up/down from the bottom/top edge to open the apps menu, then tap the  icon.

You can also find the traditional style **Internet Explorer** on the desktop.

Installing apps from Windows Store

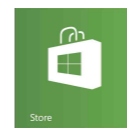

Add apps from **Windows Store**.

- 1 Connect to the Internet using either Wi-Fi or a LAN cable.
- 2 Tap the **Store** tile on the **Start** screen, then browse and install your favorite apps.

Microsoft Account

You will need a Microsoft account to use certain apps or services, including **Windows Store**.
On how to create and what you can do with a Microsoft account, refer to **Windows Help and Support** (see back page).